

Date: 8th February 2021
Ref: 210208 Pat Davie Reference
Job Ref: LUS-461

Dear Sir / Madam,

Re: Reference Letter for Pat Davie Limited

KplusK had the recent pleasure of working with Pat Davie Limited on the interior renovation of Club Lusitano, 23/F to 28/F 16 Ice House Street, Central Hong Kong. This highly complex project, involving A+A works, Minor Works, HAD Club Licensing and Liquor Licensing submissions and approvals, was delivered by PDL **on time and on budget**.

The scope of works can be summarized as follows:

23/F Member's Reception / Foyer / Multifunction Room / Administration / Library / Staff Room
24/F Bar
25/F Pastelaria / Fellowship Room
26/F Restaurant
27/F Ballroom
28/F Retiro / Private Dining

PDL were extremely helpful in managing the Client's expectations, especially regarding finishes, timeline, working hours and noisy work. Their shop drawing package, exceeding 200 A1 drawings, was meticulous and comprehensive. Their on-site team was proactive in assessing potential site issues after stripping out was completed and were also very keen to address Change Requests and Variation Orders from the Client, Architect and Project Management team in a timely, professional manner.

The project was delivered after 230 days on site, completed in April 2019. Snagging and defect rectification was carried out efficiently and to the Client's satisfaction.

We have no hesitation in recommending PDL for similar fitting out projects.

Yours Sincerely,

Paul Kember BA (Hons) Dip Arch RIBA ARB MCSD Assoc AIA

Director & Senior Architect

For and on behalf of

KplusK associates

An International Member of the Royal Institute of British Architects

Studio 818, 8/F, One Island South, 2 Heung Yip Road, Wong Chuk Hang, Hong Kong

T: (852) 2541 6828 F: (852) 2541 7885 www.kplusk.net

Club Lusitano

No. 16 Ice House Street, Central, Hong Kong

Club Lusitano is an historically significant private club set up 150 years ago to serve as the heart and home for Hong Kong's diasporic Portuguese community. However the existing premises, built in 1992, were originally designed along the lines of a private gentleman's club. The membership now has broadened and, in keeping with the times, wish to transform the club into a new series of environments that are more relevant to the membership's needs. KplusK's intent is also to develop the Club as a reflection of Portuguese culture. But instead of referring purely to historic references we are introducing the works and influences of contemporary Portuguese designers, artists and writers, thereby creating a living, dynamic Portuguese experience. The project spans over the top 5 floors of the Club's central property and is expected to open in phases, the first of which will be the relocation of the Club's administration and the building of its first pastelaria; a typical Portuguese egg tart bakery and café.



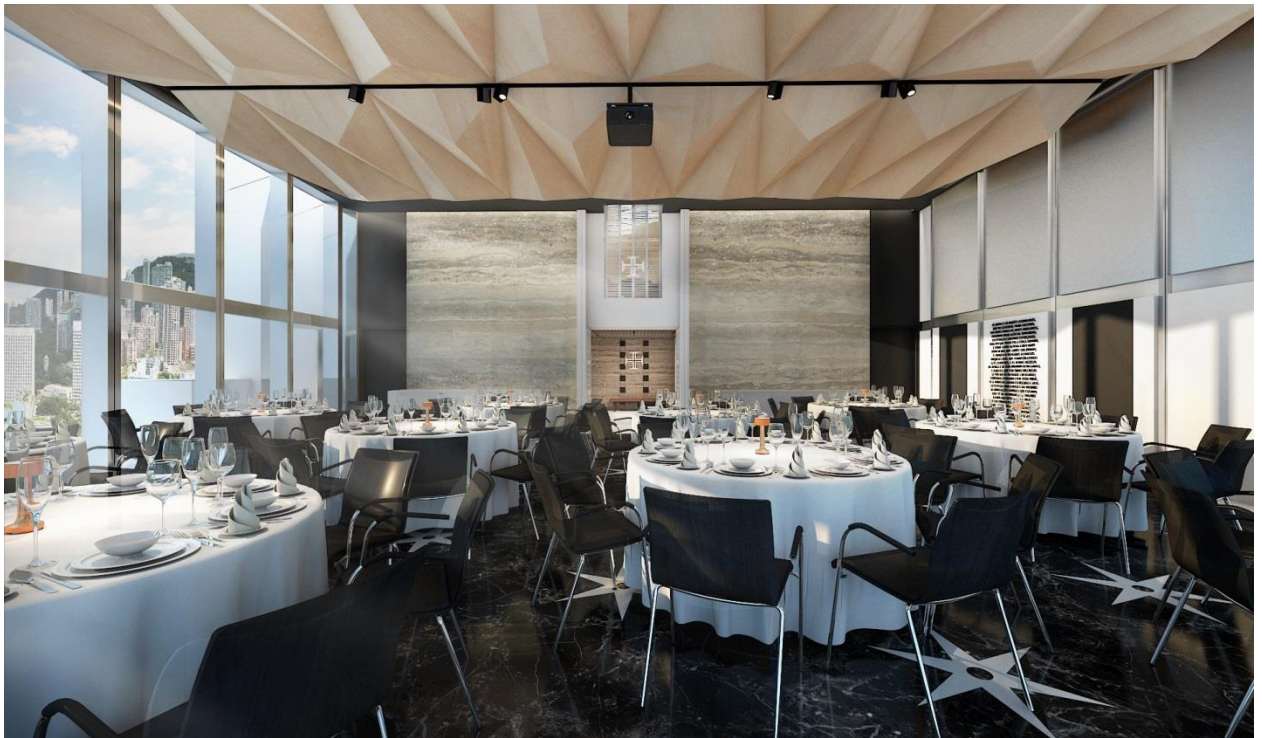



The diagram is enclosed in a large, rounded rectangle with a dashed orange border. In the center is a large, solid orange cross. On the left and right sides of the cross are two large, light-orange, stylized shapes that resemble the letter 'K' or a structural frame. At the top center, within a rounded rectangle, is the text 'Lead Consultant & Interior Designer' followed by 'KplusK associates' where 'KplusK' is in orange. At the bottom, there are six vertical rounded rectangles, each containing a role and a company name.

**Lead Consultant &
Interior Designer**
KplusK associates

**Project
Management**

Greyscale

**Cost
Management**

Rider Levett
Bucknall

**Services
Engineering**

JBA

**Structural
Engineering**

CT &
Associates

**AP & Club
Licensing
Consultant**

Wilkinson &
Cilley

**Kitchen
Consultant**

Pro-fit
Industrial Co
Ltd